

Star Spangled-QOV

9" Block

Materials:

4 Scraps of Red and 4 of Blue
in values from medium to dark
White

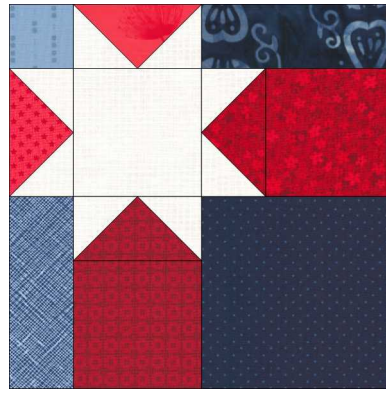

Cutting Instructions:

From lightest to darkest value of blue scraps cut:

A-2"x2" Square B-2"x5" Rectangle C-2"x5" Rectangle D-5"x5" Square

From lightest to darkest value of red scraps cut:

A-2.25"x3.75" Rectangle B-2.25"x3.75" Rectangle C-2.25"x3.75" Rectangle and 3.5"x3.5" Square

D-2.25"x3.75" Rectangle and 3.5"x3.5" Square

From white cut:

A-(8) 2.25"x2.25" Squares B-3.5"x3.5" Square

Marking:

On the back of the 2.25" white squares mark a line from corner to corner on the diagonal.

Construction:

Flying Geese Units

Take red rectangle and place 2.25" square as shown and sew along drawn line from corner to corner. Trim off the top of the corner as shown, press to the corner. Take 2nd white square and place it on the opposite side and repeat the sewing/trimming process. Trim unit to 2"x3.5".

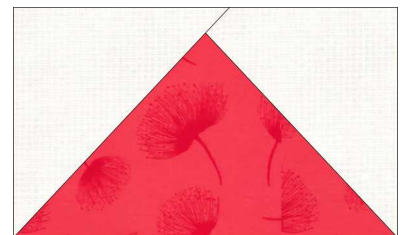
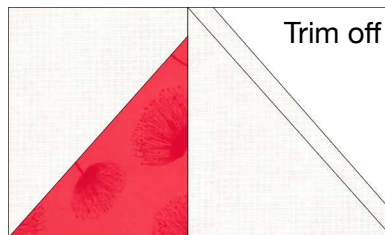
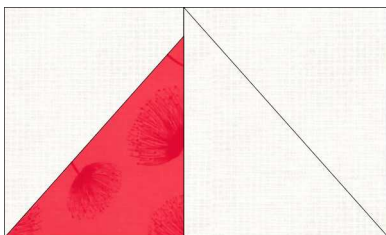
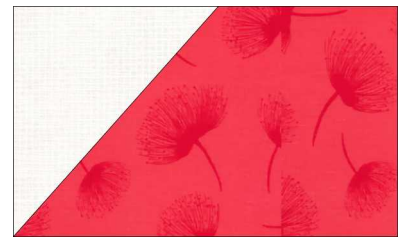
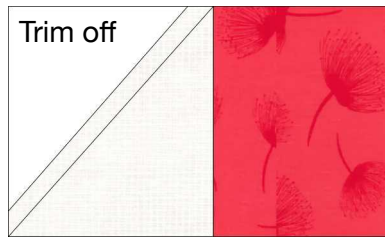
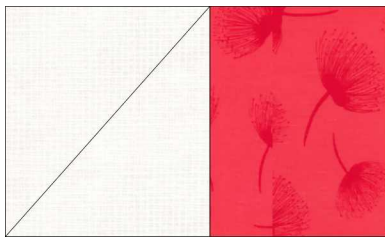

Construction continued:

Layout

Place units in position as shown below. Plus signs indicate seams and arrows indicate the direction to press for dovetail seams.

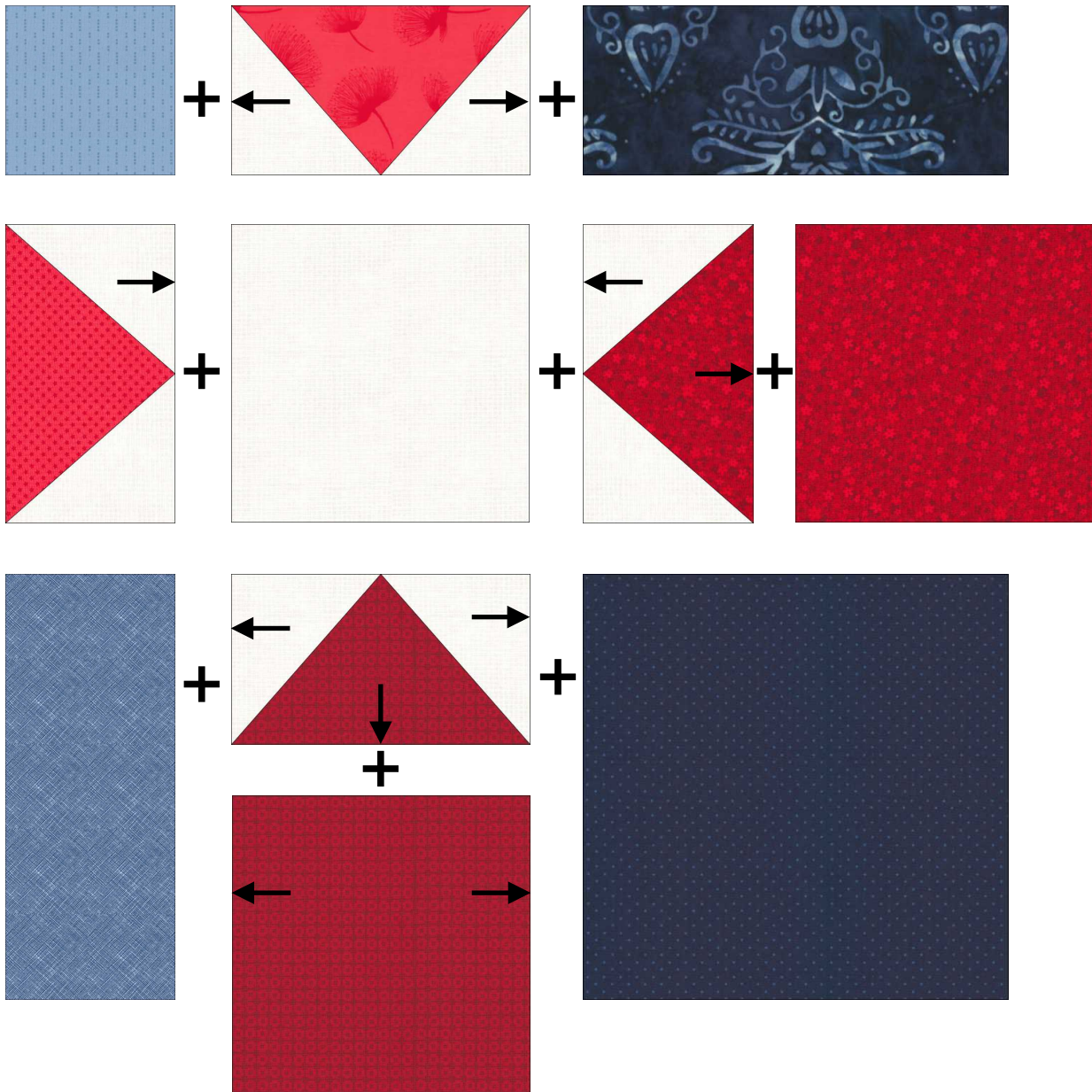

This method of pressing will help when you sew the rows together by creating dovetail seams. When you press in the direction of the arrow that means you press away from unit the arrow is placed on and toward the adjacent unit.

Once you have the rows sewn join them together and press the last 2 seams open or towards the white center. You can also switch out the colors and use blue in place of red and red in place of blue as shown on the pattern.

