

Snowman Quilt Block  
November 2020 BOM



Fabrics Needed: Blue for Background  
White or White on White for Body  
Fabric choice for Hat and Scarf  
Face – fabric, buttons, iron-on.....be creative!

Details: ¼” seam allowance  
Finished block is 12” X 12”

\*\*\*\*\*

**Hat Fabric** A (1) 4 ½ X 2 ½ rectangle  
B (2) 1 ½ squares

Note: remember the hat goes against the blue background – keep that in mind when Picking hat color

**White** C (1) 6 ½ x 5 - FACE  
D (1) 5 x 3 ½ rectangle - BODY  
E (1) 5 x 4 ½ rectangle - BODY  
F (1) 2 x 1 ½ rectangle – SCARF BOTTOM

**Scarf Fabric** J (2) 4 ½ x 1 ½ rectangle

## Background

(blue) H (6) 1 ½ squares\*

\*Note: 2 squares go next to hat, 4 squares are pressed in half for the  
Corners of the face

K (2) 3 ½ x 2 ½ rectangle

L (2) 5 x 3 ½ rectangle

M (2) 4 ½ x 1 ½ rectangle

N (2) 5 x 2 ½ rectangle

O (2) 2 ½ squares\*

\*Note: These are pressed in half for corners of the body pieces

**Face** – Be creative – Sew on fabric pieces, iron-on  
pieces or whatever you decide.

Instructions:

Make all cuts and lay out pieces according to the  
“alphabet” letter.

Before starting to sew look at the sections - Break it  
up into 4 sections – Hat, Face, Neck Scarf and  
Body

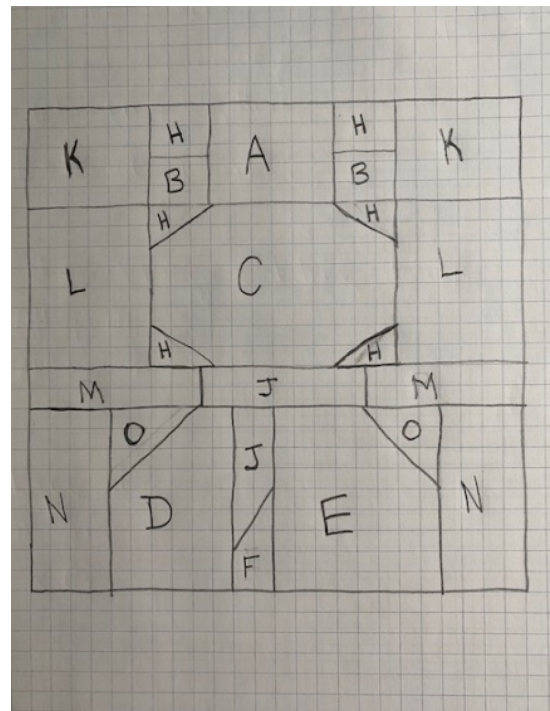

Hat: Sew both H to B and press

Sew those completed pieces to section A to make a  
rectangle.

Sew K to both ends of that rectangle.

Finished Hat.



Face: Press all remaining H pieces to make a triangle. Sew all H corner pieces along the pressed line to all corners of the face.

Press flat.

Sew both L pieces to both sides of the face.

Face finished.

Neck Scarf: Sew the M pieces to both sides of the J piece.

Neck scarf finished.

Body: Start with the scarf piece going down.

Take the J piece and the F piece and angle them and sew at a diagonal line to make one piece with two colors. See pictures Below. Scarf completed.



Move onto the body pieces around scarf.

Press the O pieces to make triangles. Now sew O corner pieces on the pressed line to the corners of the body pieces D and E.

Press flat.

Sew the scarf piece to body pieces D and E.

Sew both N pieces to both sides of the body.

Now you have 4 sections.



Completion: Now sew together all 4 sections to finish the snowman. Press flat.



Face: Be creative – Either use fabric and cut out eyes and mouth pieces and zig zag them on along with a nose. You can use iron-on pieces for the face. Or whatever you can think of.

I used iron on interfacing on the back of the eyes, nose and mouth pieces then just sewed to block.

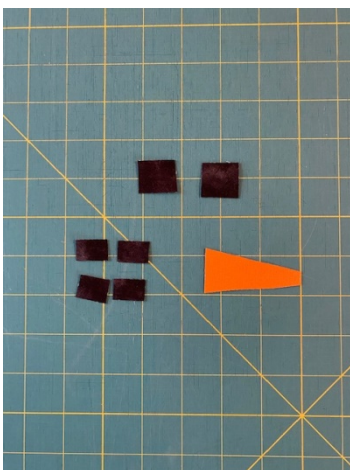

Have Fun

